

Mobile energy saving ventilation HX-M100



FUNCTION

The purpose of the mobile energy saving ventilation unit, HX-M100, is to reduce the operating cost of climate conditioned containers. By treating ambient fresh air, before it enters the internal side of a container, the solution can potentially save up to 50 % of the power consumption used to control the climate inside the container.

The HX-M100 is a small, highly efficient add-on heat exchanger unit designed to supply and exchange fresh air into containers. The unit is designed to be mounted inside the container, preferably under the roof where supply air and return air ducting also is to be placed.

The heat exchanger unit is designed to operate together with an ACM5 MKII or any other climate unit. The great **benefit** using the HX-M100 together with a climate unit is in situations where fresh air is needed.

In a conventional setup, fresh air at for example 49°C, is taken into the container and the climate unit will use energy to cool it down to for example 25°C. In order to have a constant air change inside the container some of the already cooled air at 25°C is sucked out of the container. This solution will result in waste of energy!

With an HX-M100 heat exchanger unit, the cold air is used to cool down the warmer fresh air through the heat exchanger before it enters the container. This minimizes the operation time of climate units.

FEATURES

- Designed for easy mounting in 20" or 40" containers.
- Simple user interface for adjusting the fresh air volume.
- The HX-M100 has indoor service hatches for checking and replacing filters.
- Finish is Alu-zink sheet metal and white painted front cover.
- F7 filter is available on request.
- CE-marked.

ACCESSORIES

- Package with different types of Ø100mm ducting, flexible ducting, 90° bends, ducting connections and sand trap for mounting outside container wall, in desert areas or harsh environment.
- F7 filter

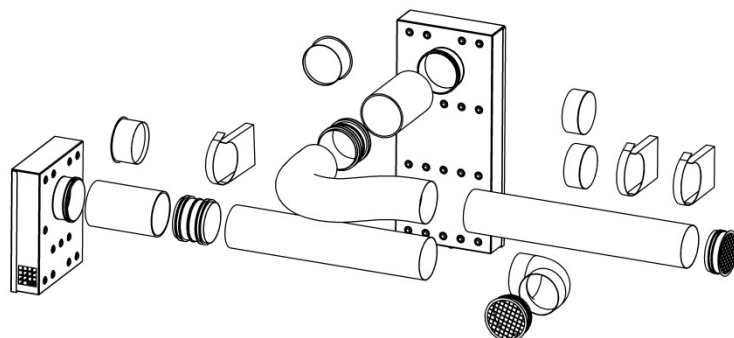



TECHNICAL DATA

NATO Stock Number	NSN	4120-22-625-7433
Operating range	°C	From TBD to +60
Airflow supply air – up to	m ³ /h	100
Airflow exhaust air – up to	m ³ /h	100
Power supply	V / Hz	1x230 / 50
Power supply plug (see picture below)	type	EURO/Schuko 10A-250V
Max. running current	A	0,3
Max. power consumption	W	61
Nominal power consumption, standard setup	W	16-25
Filter class	EN779	G4
Ingress protection class	IP	TBD
Insulation material	-	DIN 4102 B2
Noise level (stand-alone) 2 meter distance	Lp dB(A)	43
Heat exchanger efficiency	%	>80
Weight (without accessory)	Kg	25
Cabinet, AL-Zn galvanized sheet metal plate	mm	0,8
Color	RAL	9016 (white)
Air duct connection (standard setup)	Ømm	100

UNIT COMPONENTS AND AIRFLOW

1	Outdoor air intake
2	Supply air to container
3	Return air from container
4	Exhaust air
5, 6	Filters, intake and return air

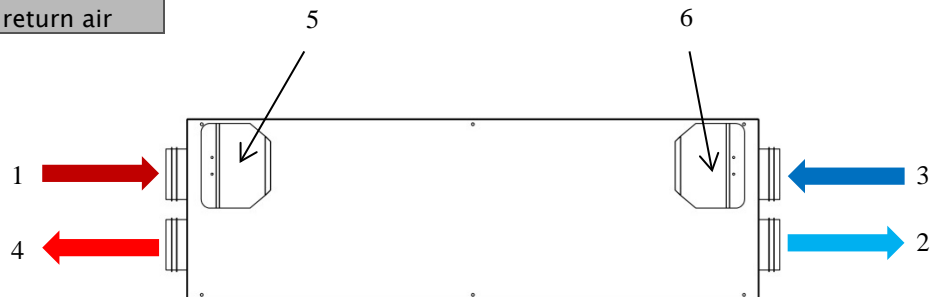

DIMENSIONS

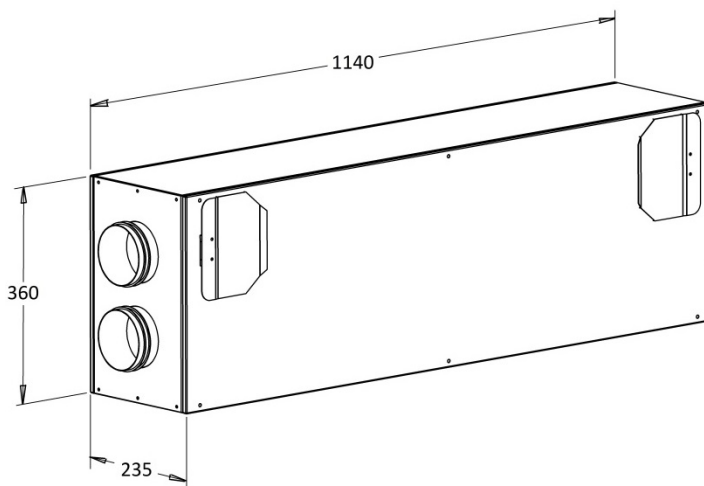

Dimensions in mm